

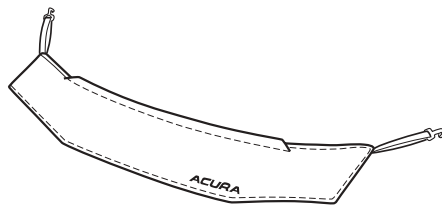

INSTALLATION INSTRUCTIONS	Accessory	Application	Publications No.
	FULL NOSE MASK P/N 08P35-S0K-200	2003 3.2TL	BII 23710
			Issue Date
			MARCH 2002

PARTS LIST

Mask (hood section)



Mask (bumper section)

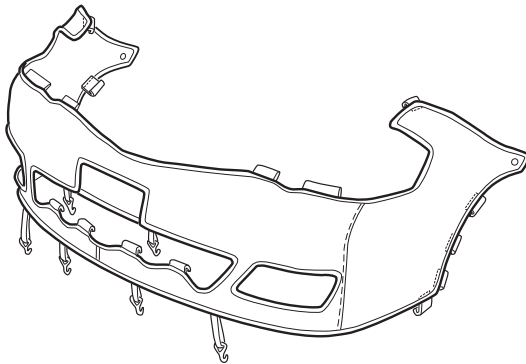

2 Snap-screws



2 Fenderwell nuts



2 Washers



Storage bag

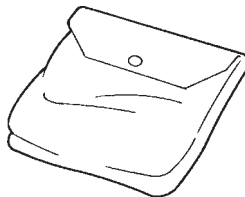

TOOLS REQUIRED

- Stubby #2 Phillips screwdriver
- Flat-tip screwdriver
- Clip remover
- Scissors

INSTALLATION

NOTE:

- Make sure the vehicle and the nose mask are clean and completely dry before installation. If moisture under the mask is allowed to dry, it may cloud the paint. If the mask gets wet, remove it and allow it to air-dry completely.
- Make sure any repainted surfaces are cured.
- Make sure the hood and nose of the vehicle have been waxed with a high-quality paste wax.
- Make sure you install the nose mask securely. If the nose mask starts to flap or comes loose while driving, safely pull off the highway, stop the vehicle, and secure or remove the mask.

Displaying the License Plate

If your state law requires the display of both license plates, cut out the piece of the bumper section that covers the front license plate:

- Face the inside of the mask toward you.
- Carefully cut the overcast stitching with scissors at the top seam, and remove the license plate section.

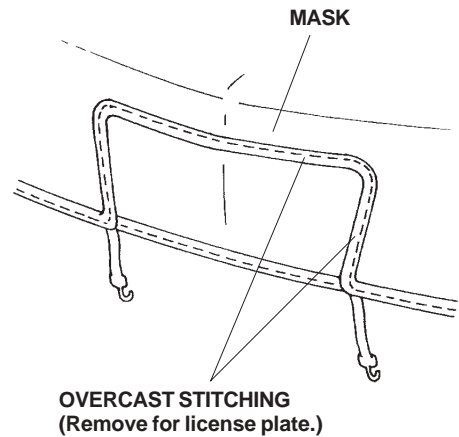

Installing the Hood Section

1. Open the hood, and remove the two hood insulator clips. (Do not discard the insulator clips; they can be reinstalled if the mask is removed.)

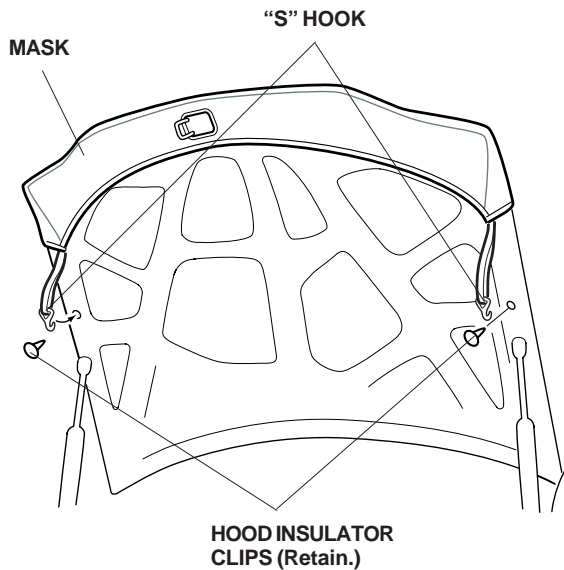

2. Fit the corners of the mask around the hood, and adjust it so it fits smoothly over the edge. Attach the two "S" hooks to the holes in hood.
3. Along the top of the hood, check that the top seam is not folded under the flap.

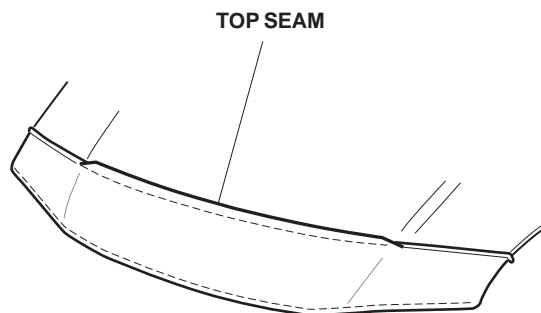

Installing the Bumper Section

4. Turn the steering wheel all the way clockwise.
5. Pry out the plastic pin, and remove the expansion clip that fastens the inner fender; remove and retain the clip, then clean the area around the hole.

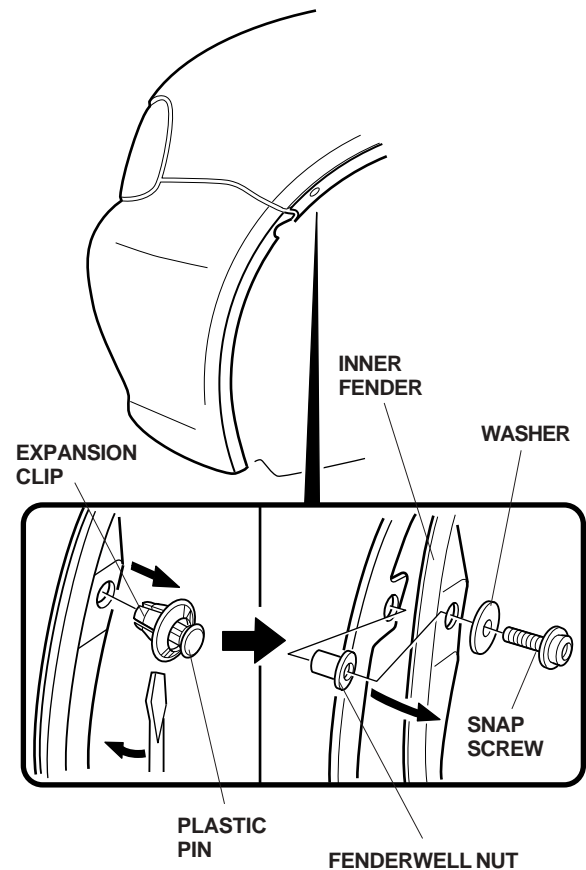

6. Pull the inner fender away, and press one fenderwell nut (supplied) into the hole in the fender flange.
7. With its washer in place, securely tighten one snap-screw into the fenderwell nut.
8. Turn the steering wheel all the way counter-clockwise, and repeat steps 5 through 7 on the other side of the vehicle.

- Slide the pocket of the mask's fender section onto the front corner of the fender, and attach the plastic clip to the top inside edge of the fender. Fit the mask across the bumper, and attach the mask to the other side in the same way.

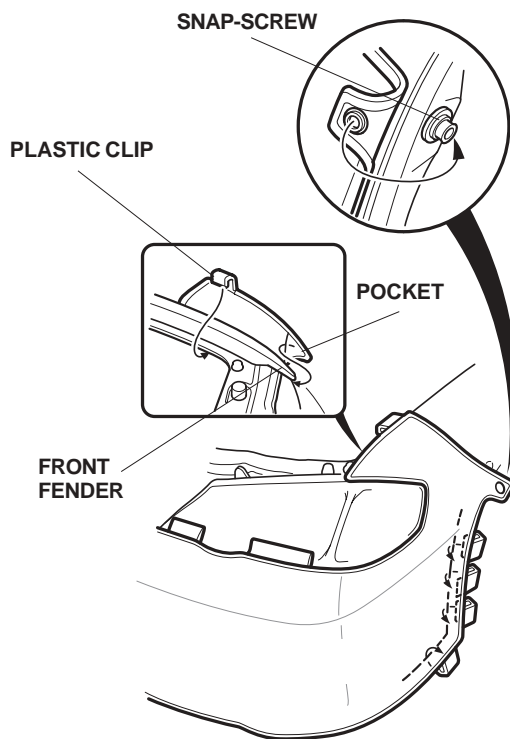

- Pull the mask back toward the wheelwell, smooth out any wrinkles, and then snap the mask onto the snap-screw. Repeat on the other side.
- On both sides of the vehicle, attach two of the three plastic clips to the fenderwell, and attach the remaining plastic clip to the bottom corner of the bumper.

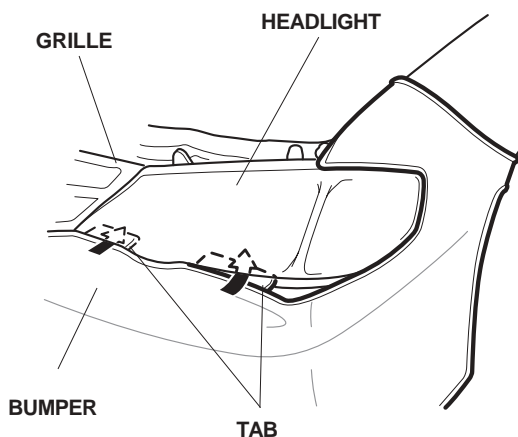

- On each side of the vehicle, insert the two tabs between the headlight and the bumper.

- Attach the two elastic straps to the inside top edge of the bumper grille.

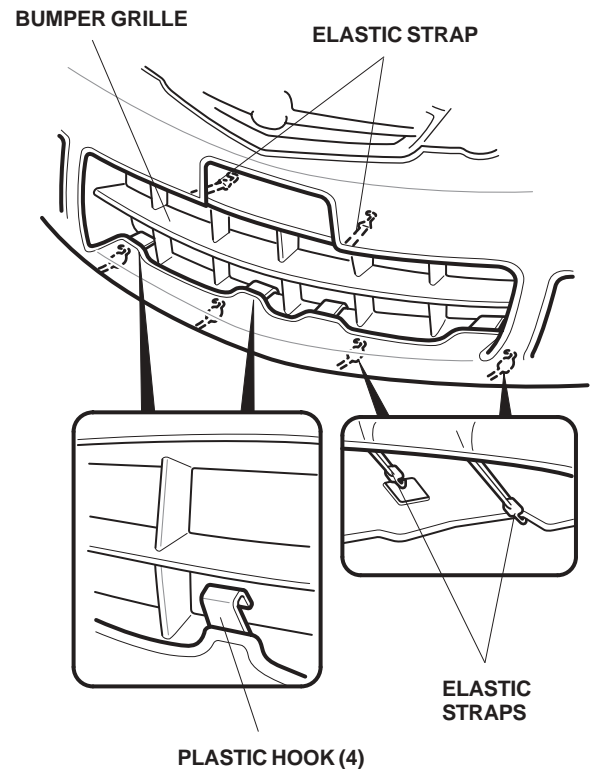

- Attach the four plastic hooks to the bottom inside edge of the bumper grille.
- Pull the mask toward the bottom edge, and attach the four elastic straps to the bottom edge of the bumper.
- Put these instructions along with the insulator clips and the plastic pins and expansion clips (removed in steps 1 and 5) into the storage bag, and place it in the trunk for future use.

CLEANING THE NOSE MASK

Use a sponge or cloth and a solution of mild liquid dishwashing soap and water to clean the vinyl and the flannel backing. Rinse the mask completely with clean water, and hang it to dry, out of direct sunlight. Make sure the mask is completely dry before you reinstall it.